

CODIGO 71657, 71658

DESCRIPCION: ELEVADOR HIDRÁULICO SIN ESCALERA

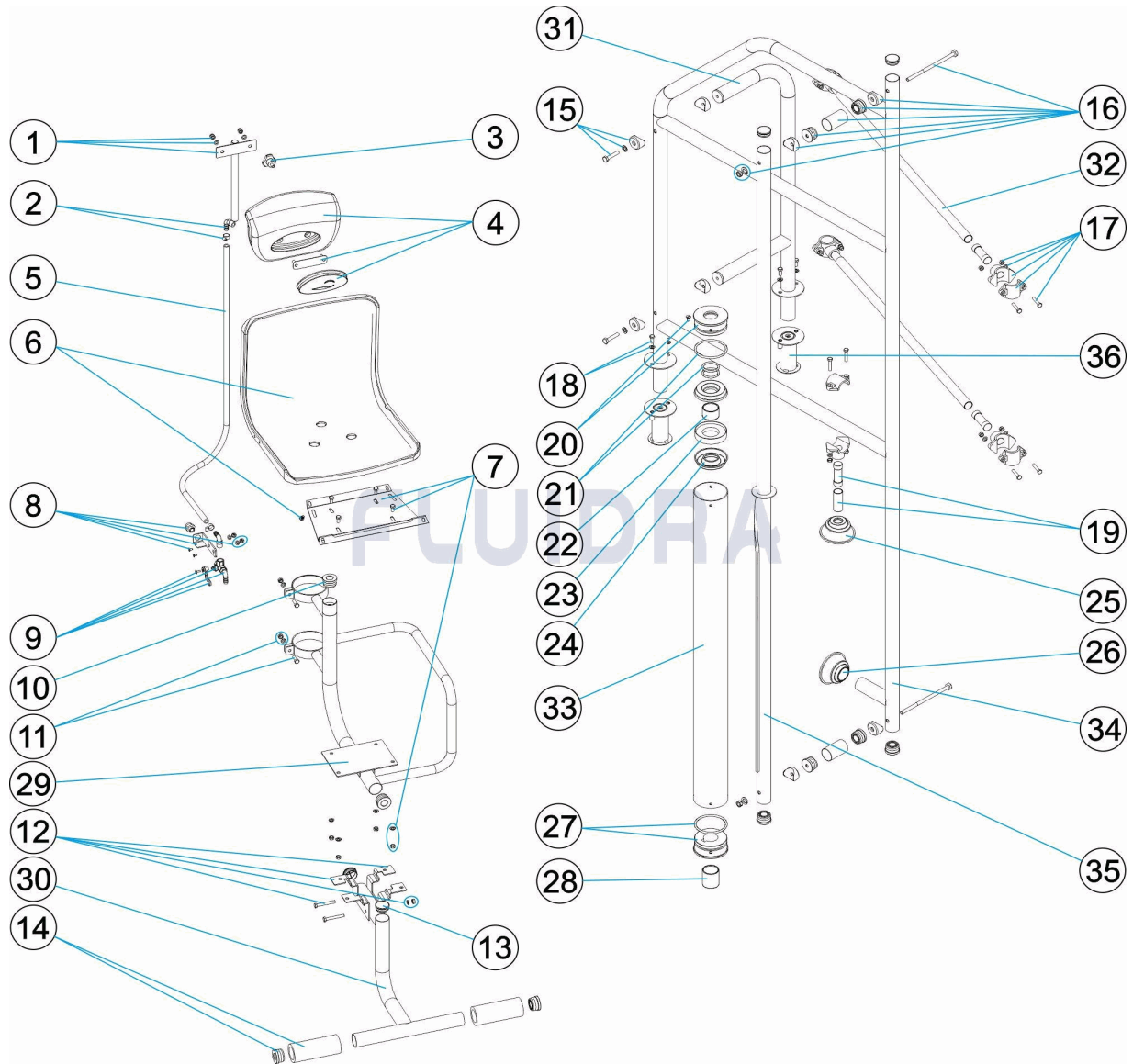

ESPAÑOL

POS	CODIGO	DESCRIPCION	CANTIDAD	POS	CODIGO	DESCRIPCION	CANTIDAD
1	4401070006	SOPORTE CABEZAL		16	4401011519	CJTO. ENLACE UNION	
2	4401011502	CODO Y BRIDA		17	4401011520	BRIDA APOYO	
3	4401050109	POMO FRENO ENROLLADOR		18	4401010008	TORNILLERIA PELDAÑO	
4	4401140022	REPOSA CABEZAS		19	4401140017	SOPORTE INFERIOR	
5	4401011514	TUBO ENTRADA 0,9 M		20	4401011517	TAPA GUIA SUPERIOR	
6	4401011518	ASIENTO		21	4401011501	JUNTAS ELEVADOR	
7	4401011507	PLACA ASIENTO		22	4401011505	CASQUILLO TOPE INFERIOR	
8	4401011515	SOPORTE VALVULA		23	4401011516	APOYO JUNTA	
9	4401011508	VALVULA 3 VIAS COMPLETA		24	4401011509	JUNTA ELEVADOR	
10	4401050402	CASQUILLOS GUIA		25	4401011506	TOPE ARTICULADO D.28	
11	4401140006	TORNILLERIA PLATAFORMA		26	4401010501	TOPE ARTICULADO	
12	4401140023	TORNILLERIA FIJACION SOPORTE		27	4401011513	CASQUILLO GUIA	
13	4401070208	TAPON D.43		28	4401011512	CASQUILLO DE SEGURIDAD	

CODIGO **71657, 71658**

DESCRIPCION: **ELEVADOR HIDRÁULICO SIN ESCALERA**

14	4401140024	PROTECTOR SOPORTE PIES	29	71184R0100	ESTRUCTURA SILLA ELEVADOR
15	4401140025	ENLACE UNION	30	71186R0200	SOPORTE APOYO PIES
31	71183R0200	SOPORTE PASAMANO	34	* 71182R0100	PASAMANO A-650
32	* 71182R0730	TRAVESAÑO UNION L-550	34	* 71183R0100	PASAMANO A-1000
32	* 71183R0730	TRAVESAÑO UNION L-880	35	11277R0100	CONJUNTO TUBO GUIA
33	11277R0600	CILINDRO ELEVADOR HIDRAULICO	36	00143	ANCLAJE FIJACION CON TORNILLOS

CODIGO **71657, 71658**DESCRIPCION: **ELEVADOR HIDRÁULICO SIN ESCALERA****OBSERVACIONES**

POS	CODIGO	OBSERVACIONES
32	* 71182R0730	PARA: 71657
32	* 71183R0730	PARA: 71658
34	* 71182R0100	PARA: 71657
34	* 71183R0100	PARA: 71658

CODE 71657, 71658

DESCRIPTION: ÉLÉVATEUR HYDRAULIQUE SANS ÉCHELLE

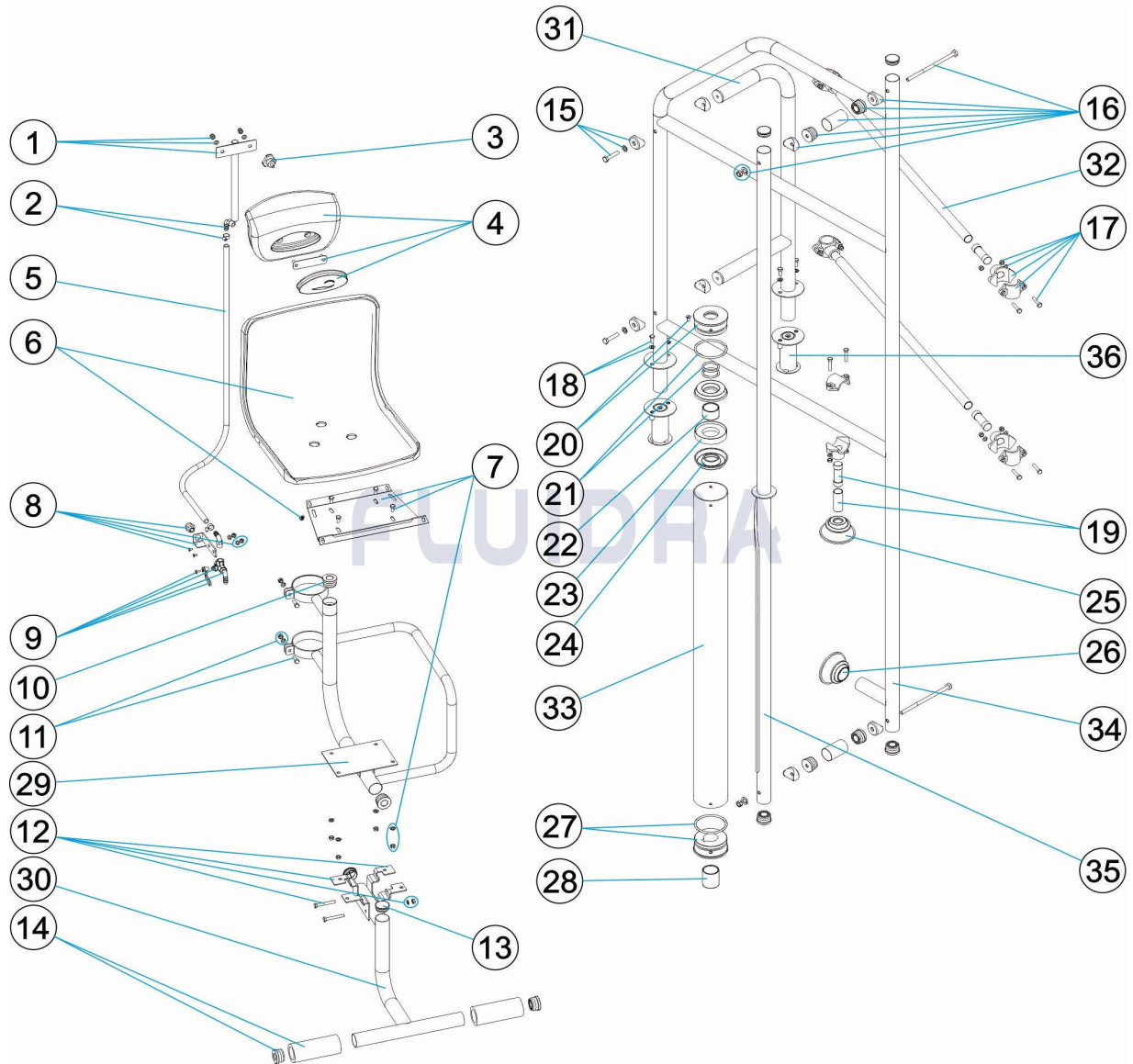

FRANCAIS

POS	CODE	DESCRIPTION	QUANTITE	POS	CODE	DESCRIPTION	QUANTITE
1	4401070006	SUPPORT APPUIE-TÊTE		16	4401011519	ENSEMBLE RACCORD UNION	
2	4401011502	COUDE ET BRIDE		17	4401011520	BRIDE DE SUPPORT	
3	4401050109	VIS DE FREINAGE ENROULEUR		18	4401010008	VISSERIE MARCHE	
4	4401140022	APPUIE-TÊTE		19	4401140017	SUPPORT INFÉRIEUR	
5	4401011514	TUBE ENTRÉE 0,9 M.		20	4401011517	COUVERCLE GUIDE SUPÉRIEUR	
6	4401011518	SEAT		21	4401011501	JOINT ELEVATEUR	
7	4401011507	PLAQUE SUPPORT DE SIEGE		22	4401011505	DOUILLES	
8	4401011515	SUPPORT VANNE		23	4401011516	SUPPORT DE JOINT	
9	4401011508	VANNE 3 VOIES COMPLETE		24	4401011509	JOINT ELEVATEUR	
10	4401050402	DOUILLES		25	4401011506	TAMPON ARTICULÉ D 28	
11	4401140006	VIS PLATE-FORME		26	4401010501	TAMPON ARTICULÉ	
12	4401140023	VIS DE FIXATION DU SUPPORT		27	4401011513	DOUILLE GUIDE	
13	4401070208	BOUCHON D.43		28	4401011512	DOUILLE DE SÉCURITÉ	

CODE **71657, 71658**

DESCRIPTION: **ÉLÉVATEUR HYDRAULIQUE SANS ÉCHELLE**

14	4401140024	PROTECTEUR REPOSE-PIEDS	29	71184R0100	STRUCTURE FAUTEUIL ÉLÉVATEUR
15	4401140025	RACCORD UNION	30	71186R0200	SUPPORT REPOSE-PIEDS
31	71183R0200	SUPPORT MAIN COURANTE	34	* 71182R0100	MAIN COURANTE A-650
32	* 71182R0730	TRAVERSE UNION L-550	34	* 71183R0100	MAIN COURANTE A-1000
32	* 71183R0730	TRAVERSE UNION L-880	35	11277R0100	ENSEMBLE TUBE GUIDE
33	11277R0600	CYLINDRE ÉLÉVATEUR	36	00143	FIXATION AVEC VIS

CODE **71657, 71658**

DESCRIPTION: **ÉLÉVATEUR HYDRAULIQUE SANS ÉCHELLE**

OBSERVATIONS

POS	CODE	OBSERVATIONS
32	* 71182R0730	POUR: 71657
32	* 71183R0730	POUR: 71658
34	* 71182R0100	POUR: 71657
34	* 71183R0100	POUR: 71658

CODE 71657, 71658

DESCRIPTION: HYDRAULIC LIFT WITHOUT LADDER

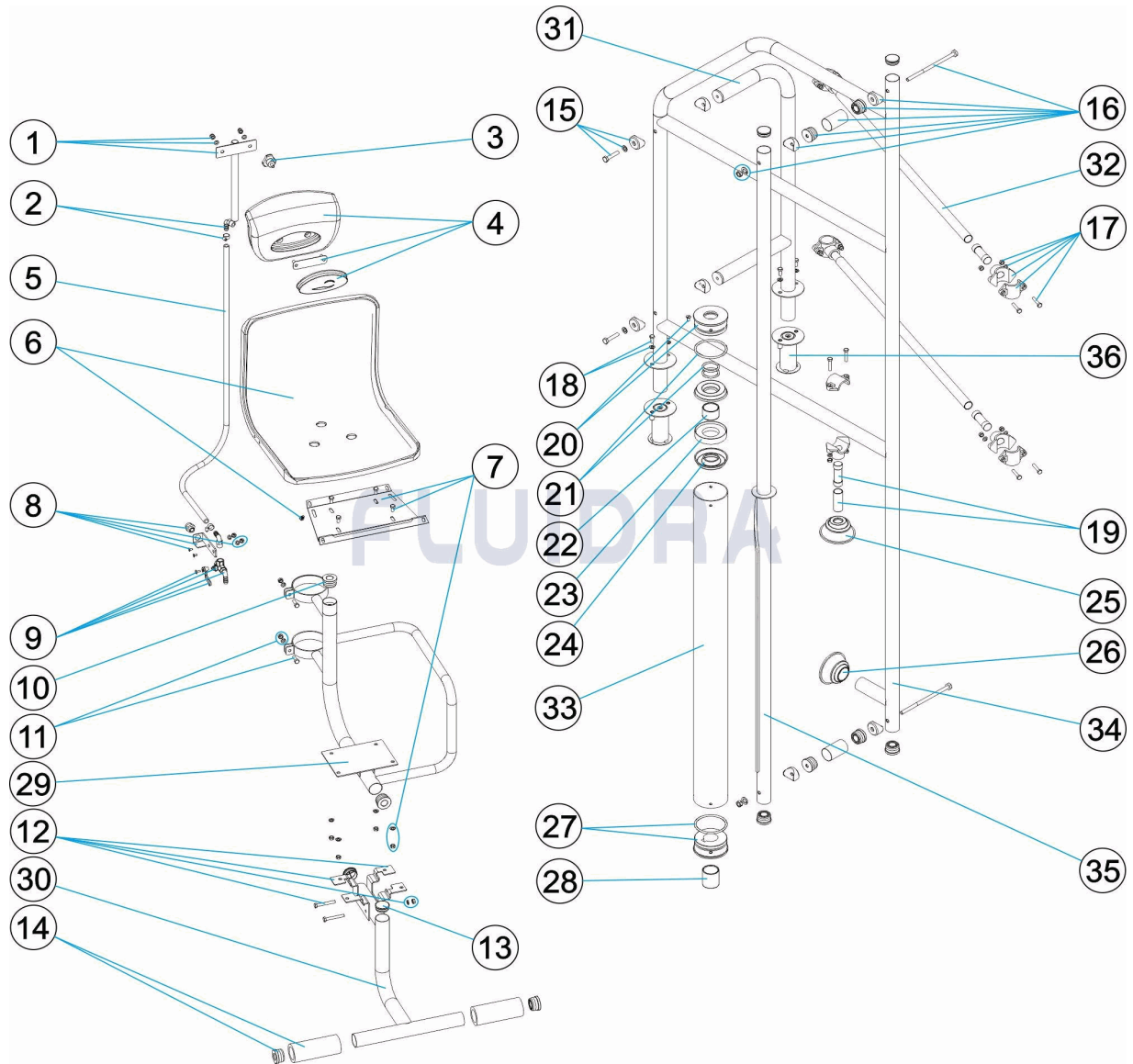

ENGLISH

POS	CODE	DESCRIPTION	QUANTITY	POS	CODE	DESCRIPTION	QUANTITY
1	4401070006	HEAD SUPPORT		16	4401011519	UNION KIT	
2	4401011502	ELBOW AND FLANGE		17	4401011520	SUPPORT DASP	
3	4401050109	ROLLER BRAKE KNOB		18	4401010008	TREAD BOLT SET	
4	4401140022	HEAD REST		19	4401140017	LOWER SUPPORT	
5	4401011514	PIPE 0.9 M.		20	4401011517	SUPERIOR GUIDE COVER	
6	4401011518	SIÈGE		21	4401011501	LIFTER GASKETS	
7	4401011507	CHAIR PLATE		22	4401011505	SOCKETS	
8	4401011515	VALVE SUPPORT		23	4401011516	SEAL SUPPORT	
9	4401011508	COMPLETE 3-WAY VALVE		24	4401011509	LIFTER GASKET	
10	4401050402	BUSHES		25	4401011506	ARTICULATED FOOT PAD D 28	
11	4401140006	PLATFORM FIXINGS		26	4401010501	ARTICULATED FOOT PAD	
12	4401140023	SUPPORT BOLT SET		27	4401011513	GUIDE SOCKET	
13	4401070208	PLUG D.43		28	4401011512	SECURITY SOCKET	

* SEE OBSERVATIONS SHEET

CODE **71657, 71658**

DESCRIPTION: **HYDRAULIC LIFT WITHOUT LADDER**

14	4401140024	PROTECTIVE FOOT REST	29	71184R0100	LIFT SEAT STRUCTURE
15	4401140025	UNION	30	71186R0200	FOOT REST BRACKET
31	71183R0200	HANDRAIL SUPPORT	34	* 71182R0100	A-650 HANDRAIL
32	* 71182R0730	L-550 CONNECTION PIPES	34	* 71183R0100	A-1000 HANDRAIL
32	* 71183R0730	L-880 CONNECTION PIPES	35	11277R0100	MECHANICAL TUBE
33	11277R0600	HYDRAULIC CYLINDER TUBE	36	00143	ANCHORING WITH SCREWS

CODE **71657, 71658**

DESCRIPTION: **HYDRAULIC LIFT WITHOUT LADDER**

OBSERVATIONS

POS	CODE	OBSERVATIONS
32	* 71182R0730	FOR: 71657
32	* 71183R0730	FOR: 71658
34	* 71182R0100	FOR: 71657
34	* 71183R0100	FOR: 71658

CODICE 71657, 71658

DESCRIZIONE: ELEVATORE IDRAULICO SENZA SCALA

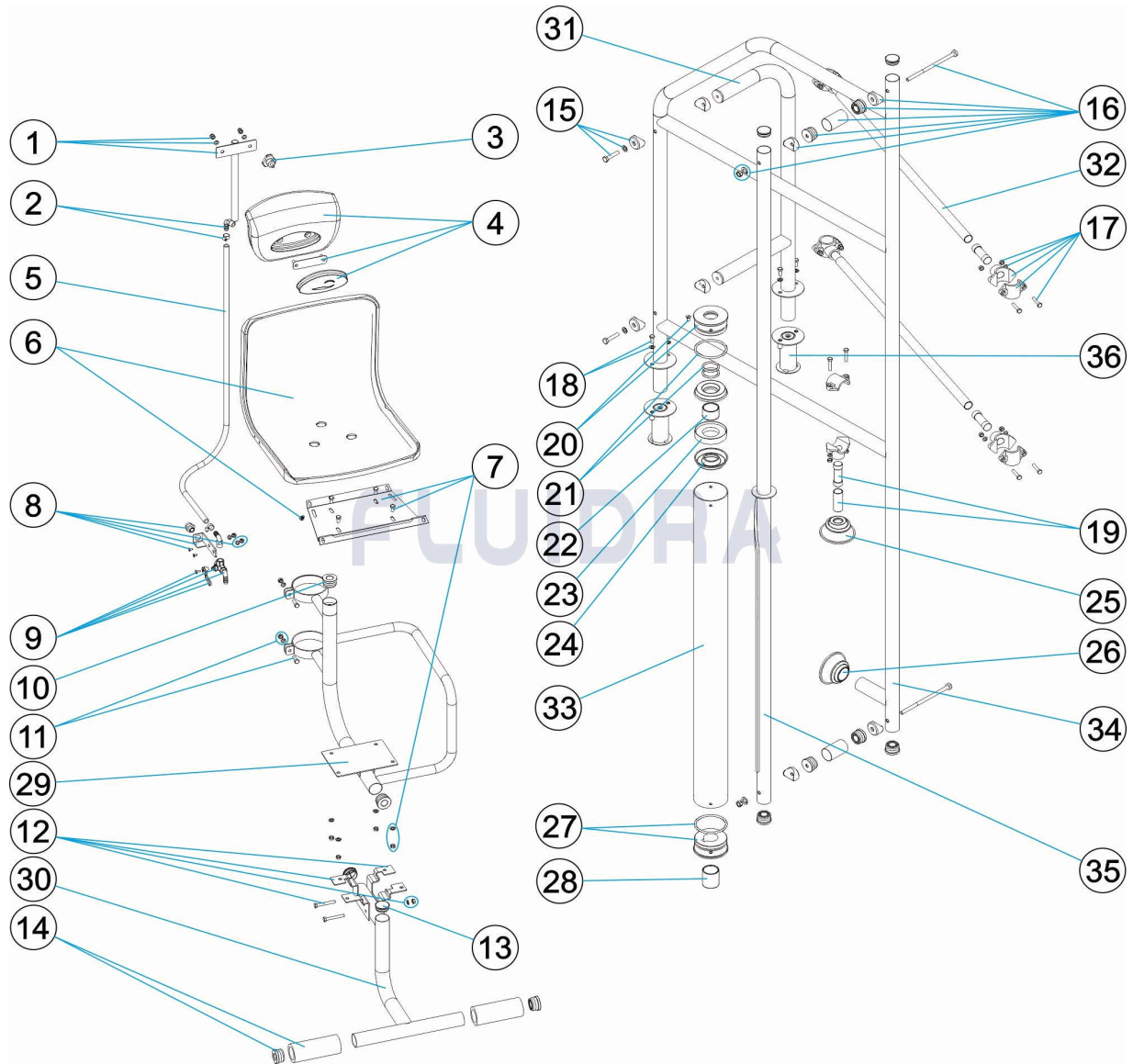

ITALIANO

POS	CODICE	DESCRIZIONE	QUANTITA'	POS	CODICE	DESCRIZIONE	QUANTITA'
1	4401070006	SUPPORTO TESTINA		16	4401011519	KIT ATTACO SEIDA	
2	4401011502	GOMITO E FLANGIA		17	4401011520	PRESA A STAFFA SOSTEGNO	
3	4401050109	POMELLO FRENO RULLO		18	4401010008	BULLONERIA GRADINO	
4	4401140022	RIPOSA TESTINE		19	4401140017	SUPPORTO INFERIORE	
5	4401011514	TUBO ENTRATA 0,9 M.		20	4401011517	TAPPO GUIDA SUPERIORE	
6	4401011518	SEIDA		21	4401011501	GUARNIZIONI SOLLEVATORE	
7	4401011507	PIASTRA SEGGIOLA		22	4401011505	PASSANTI	
8	4401011515	SUPPORTO VALVOLA		23	4401011516	SUPPORTO GUARNIZIONE	
9	4401011508	VALVOLA A 3 VIE COMPLETA		24	4401011509	GUARNIZIONE SOLLEVATORE	
10	4401050402	PASSANTI		25	4401011506	PIEDINO SNODABILE D 28	
11	4401140006	KIT VITI PIATTAFORMA		26	4401010501	PIEDINO SNODABILE	
12	4401140023	BULLONERIA PER FISSAGGIO SUPPORTO		27	4401011513	TAPPO CON GUIDA	
13	4401070208	TAPPO D.43		28	4401011512	TAPPO DI SICUREZZA	

* SI FACCIA RIFERIMENTO AL FOGLIO DELLE OSSERVAZIONI

CODICE **71657, 71658**

DESCRIZIONE: **ELEVATORE IDRAULICO SENZA SCALA**

14	4401140024	PROTEZIONE APPOGGIO PIEDI	29	71184R0100	STRUTTURA SEDIA ELEVATRICE
15	4401140025	ATTACO SEIDA	30	71186R0200	SUPPORTO APPOGGIO PIEDI
31	71183R0200	SUPPORTO PASSAMANO	34	* 71182R0100	CORRIMANO A-650
32	* 71182R0730	TRAVERSA UNIONE L-550	34	* 71183R0100	CORRIMANO A-1000
32	* 71183R0730	TRAVERSA UNIONE L-880	35	11277R0100	KIT CILINDRO GUIDA
33	11277R0600	CILINDRO ELEVATORE	36	00143	ANCORAGGIO DI FISSAGGIO CON VITI

CODICE 71657, 71658

DESCRIZIONE: ELEVATORE IDRAULICO SENZA SCALA

OSSERVAZIONI

POS	CODICE	OSSERVAZIONI
32	* 71182R0730	PER: 71657
32	* 71183R0730	PER: 71658
34	* 71182R0100	PER: 71657
34	* 71183R0100	PER: 71658

CODE 71657, 71658

BESCHREIBUNG: HYDRAULISCHER LIFTER OHNE TREPPE

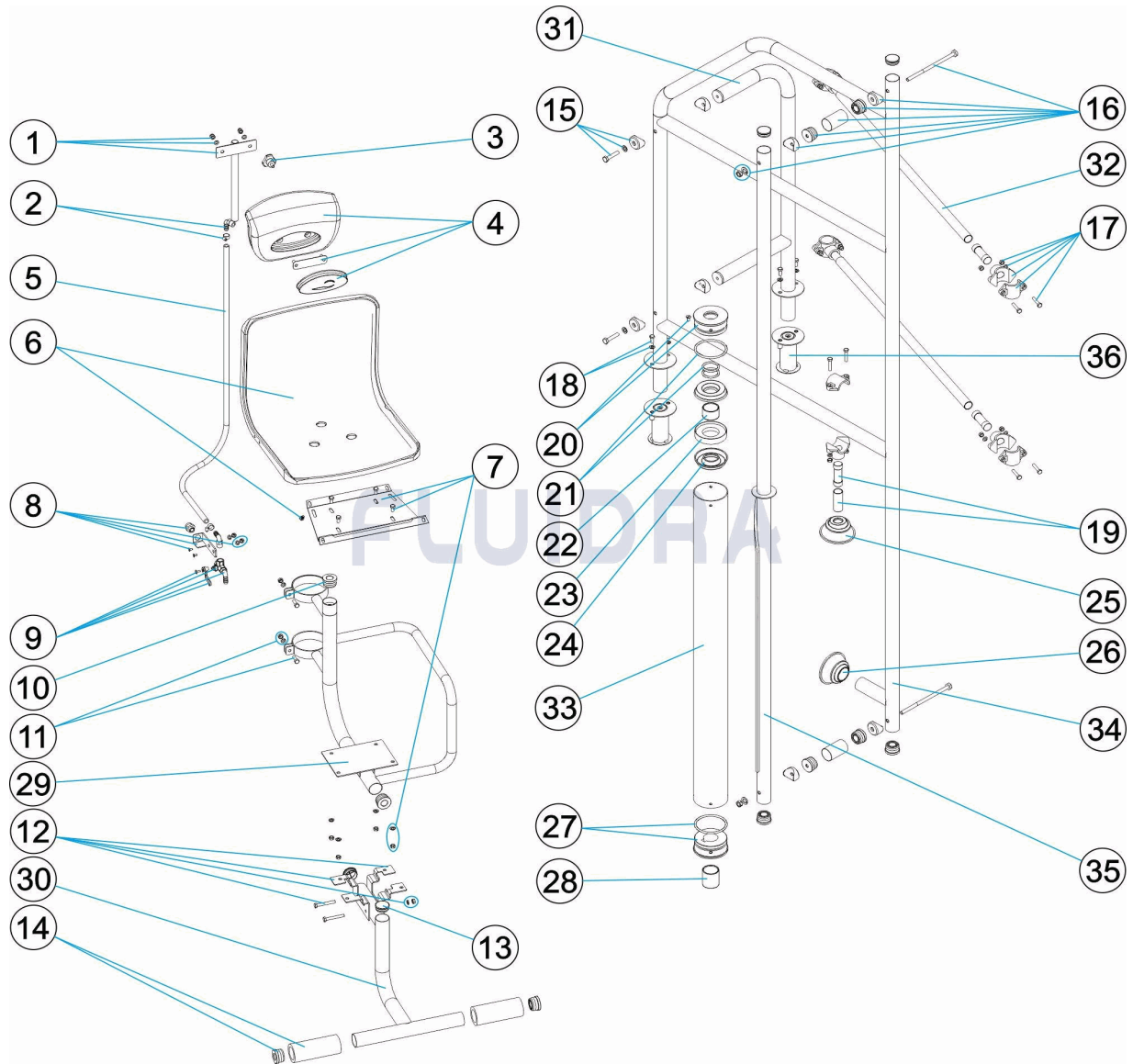

DEUTSCH

POS	CODE	BESCHREIBUNG	MENGE	POS	CODE	BESCHREIBUNG	MENGE
1	4401070006	HALTERUNG KOPFSTÜCK		16	4401011519	SET ANSCHLUSSVERBINDUNG	
2	4401011502	WINKEL UND FLANSCH		17	4401011520	HILFSFLANSCH	
3	4401050109	BREMSSCHNUR HASPEL		18	4401010008	SCHRAUBENSATZ STUFE	
4	4401140022	KOPFSTÜTZ		19	4401140017	HALTERUNG UNTEN	
5	4401011514	ROHR EINGANG 0,9 M		20	4401011517	ABDECKUNG FÜHRUNG OBEN	
6	4401011518	SITZ		21	4401011501	DICHTUNGEN LIFT	
7	4401011507	PLATINE SITZ		22	4401011505	FASSUNG ABSCHLUSS UNTEN	
8	4401011515	HALTERUNG VENTIL		23	4401011516	HALTERUNG DICHTUNG	
9	4401011508	3-WEGE-VENTIL KOMPLETT		24	4401011509	DICHTUNG LIFT	
10	4401050402	FASSUNGEN FÜHRUNG		25	4401011506	BEWEGLICHER ABSCHLUSS D. 28	
11	4401140006	SCHRAUBENSATZ PLATTFORM		26	4401010501	BEWEGLICHER ABSCHLUSS	
12	4401140023	FIXIERSCHRAUBEN HALTERUNG		27	4401011513	FASSUNG FÜHRUNG	
13	4401070208	STOPFEN D.43		28	4401011512	SICHERHEITSSCHRAUBE	

* SIEHE ANMERKUNGSBLATT

CODE **71657, 71658**

BESCHREIBUNG: **HYDRAULISCHER LIFTER OHNE TREPPE**

14	4401140024	SCHUTZFUSSABLAGE	29	71184R0100	STRUKTUR HEBESITZ
15	4401140025	ANSCHLUSSVERBINDUNG	30	71186R0200	HALTERUNG FUSSABLAGE
31	71183R0200	ABSTANDHALTERSATZ LEITER	34	* 71182R0100	HANDLAUF A-650
32	* 71182R0730	QUERTEIL VERBINDUNG L-550	34	* 71183R0100	HANDLAUF A-1000
32	* 71183R0730	QUERTEIL VERBINDUNG L-880	35	11277R0100	SET FÜHRUNGSRÖHR
33	11277R0600	ZYLINDER LIFT HYDRAULISCH	36	00143	VERANKERUNG FIXIERUNG MIT SCHRAUB

CODE **71657, 71658**

BESCHREIBUNG: **HYDRAULISCHER LIFTER OHNE TREPPE**

HINWEISE

POS	CODE	HINWEISE
32	* 71182R0730	FÜR: 71657
32	* 71183R0730	FÜR: 71658
34	* 71182R0100	FÜR: 71657
34	* 71183R0100	FÜR: 71658

CODIGO 71657, 71658

DESCRIÇÃO: ELEVADOR HIDRÁULICO SEM ESCADA

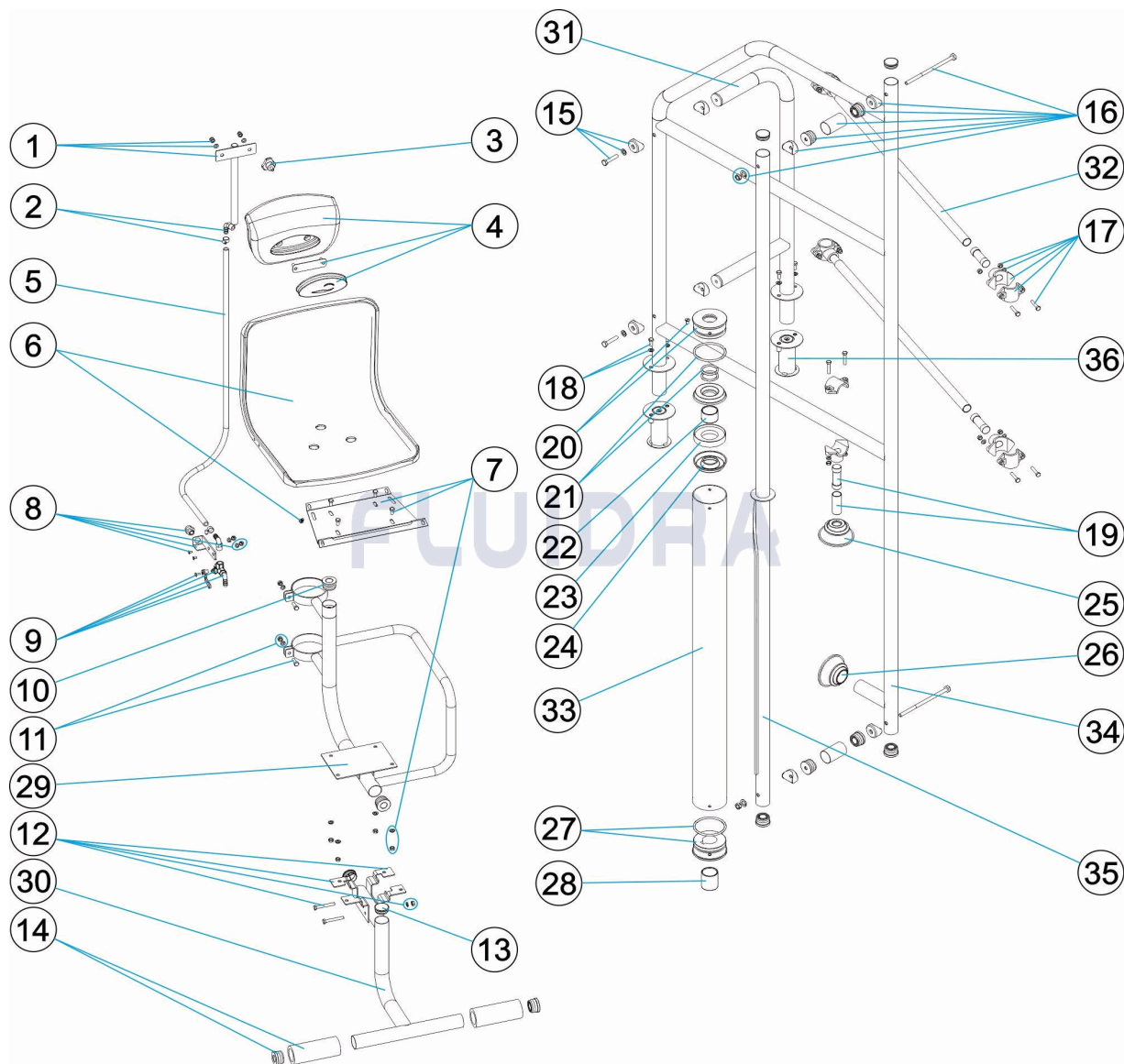

PORTUGUES

POS	CODIGO	DESCRIÇÃO	JANTIDADE	POS	CODIGO	DESCRIÇÃO	JANTIDADE
1	4401070006	SUPORTE APOIO DE CABEÇA		16	4401011519	CONJUNTO UNIÃO LIGAÇÃO	
2	4401011502	COTOBELO E FLANGE		17	4401011520	ABRACADEIRA DE APOIO	
3	4401050109	MANIPULO TRAVÃO ENROLADOR		18	4401010008	PARAFUSOS DEGRAU	
4	4401140022	REPOUSA CABEÇAS		19	4401140017	SUPORTE INFERIOR	
5	4401011514	TUBO ENTRADA 0,9 M.		20	4401011517	TAMPA GUIA SUPERIOR	
6	4401011518	CADEIRA		21	4401011501	JUNTAS ELEVADOR	
7	4401011507	PLACA ASSENTO		22	4401011505	CASQUILHOS	
8	4401011515	SUPORTE VÁLVULA		23	4401011516	APOIO JUNTA	
9	4401011508	VALVULA 3 VIAS COMPLETA		24	4401011509	JUNTA ELEVADOR	
10	4401050402	CONJ. CASQUILHOS		25	4401011506	BATENTE ARTICULADA D 28	
11	4401140006	CONJ. PARAFUSOS PLATAFORMA		26	4401010501	BATENTE ARTICULADA	
12	4401140023	CONJ. PARAFUSOS SUPORTE		27	4401011513	CASQUILHO GUIA	
13	4401070208	TAMPÃO D.43		28	4401011512	CASQUILHO DE SEGURANÇA	

CODIGO 71657, 71658

DESCRIÇÃO: ELEVADOR HIDRÁULICO SEM ESCADA

14	4401140024	PROTECTOR APOIO PÉS	29	71184R0100	ESTRUTURA CADEIRA ELEVADOR
15	4401140025	UNIÃO LIGAÇÃO	30	71186R0200	SUPORTE APOIO PÉS
31	71183R0200	SUPORTE CORRIMÃO	34	* 71182R0100	CORRIMÃO A-650
32	* 71182R0730	TRAVESSA UNIÃO L-550	34	* 71183R0100	CORRIMÃO A-1000
32	* 71183R0730	TRAVESSA UNIÃO L-880	35	11277R0100	CONJUNTO TUBO GUÍA
33	11277R0600	CILINDRO ELEVADOR	36	00143	ANCORAGEM FIXAÇÃO COM PARAFUSOS

CODIGO 71657, 71658

DESCRIÇÃO: ELEVADOR HIDRÁULICO SEM ESCADA

OBSERVAÇÕES

POS	CODIGO	OBSERVAÇÕES
32	* 71182R0730	PARA: 71657
32	* 71183R0730	PARA: 71658
34	* 71182R0100	PARA: 71657
34	* 71183R0100	PARA: 71658